

BORDEAUX VILLAGE CONDOMINIUMS



Important Landscaping Notice Tree Removals



July 7, 2010

Dear Residents,

Some trees in the community have raised concern regarding existing damage and the possibility of further damage to the building structures and foundations at Bordeaux Village. Please be advised that your Board of Directors and CCMC have worked together and sought the opinions of several industry professionals including the city arborists, the landscape designer for your Association, and your current landscape maintenance provider. All support the opinion that these trees should be removed.

Jonmar will begin removing the trees tomorrow, Thursday, July 8, 2010.

On the reverse side of this notice, you'll find a map and list of local trees to be removed.

Thank you for your patience and cooperation.
Your CCMC Management Team
469-246-3500

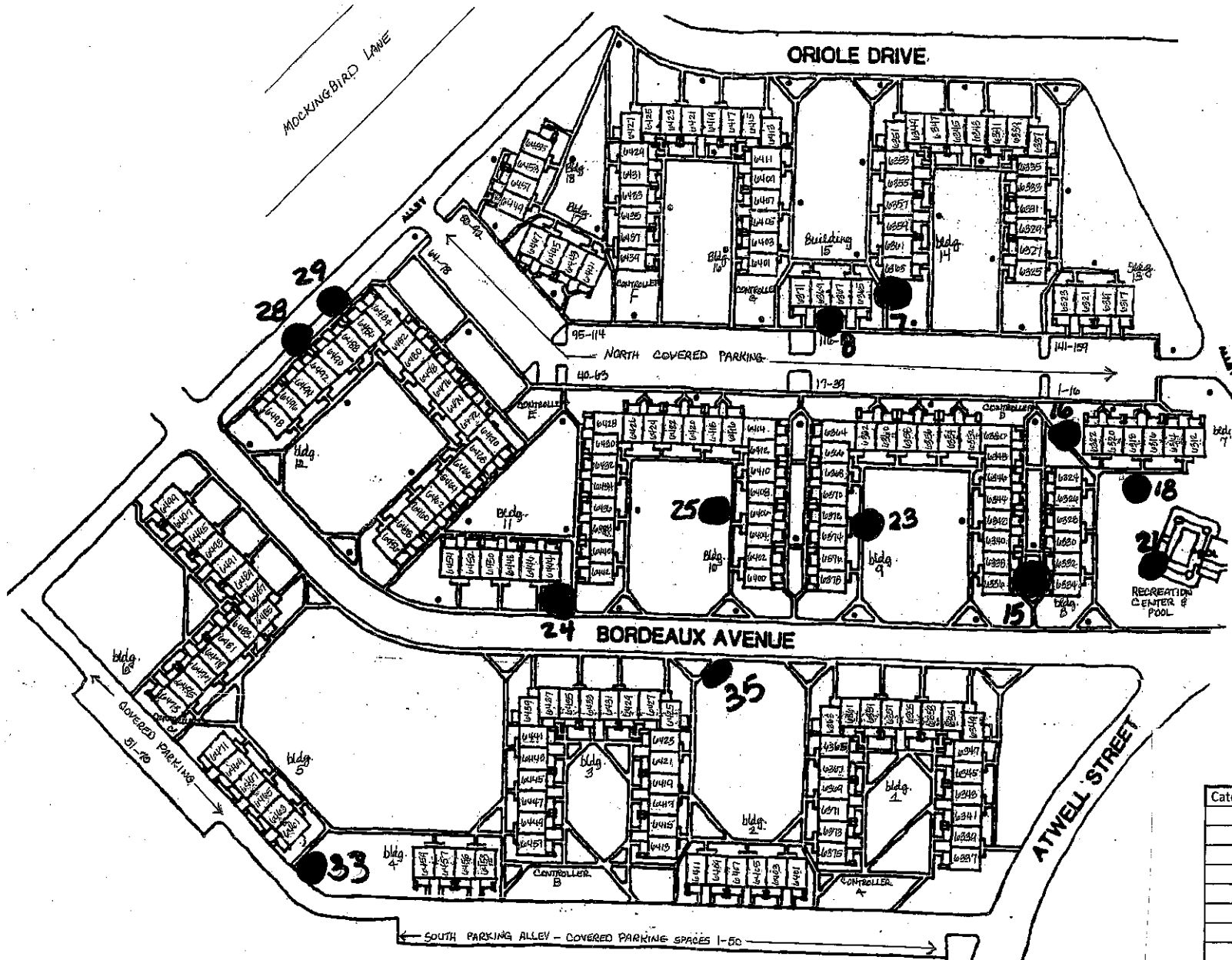

BORDEAUX VILLAGE SITE PLAN

Bordeaux Village
Tree Work

Category	#	Type
2	7	HACKBERRY
2	8	COTTON WOOD
2	15	WILLOW
2	16	WILLOW
2	18	SYCAMORE
2	21	SYCAMORE
2	23	ELM
2	24	WILLOW
2	25	SYCAMORE
2	28	MULBERRY
2	29	MULBERRY
2	33	CHERRY LUREL
2	35	BRADFORD PEAR