

Bordeaux Village News

Maintenance and Rehab Project Update

Visible Wiring/Cabling Compliance

April 20, 2010

If you have a satellite dish (or visible exterior telephone and cable wires), please review this document carefully.

Visible Wires To Be Brought Into Compliance

To follow up with an earlier communication, as the new construction has continued, it has become obvious that Bordeaux Village must require residents to comply with the long-standing community standard that does not permit wires to be attached to the outside walls. All wires tacked to exterior walls will be loosened to allow painting of brick and trim. Subsequently, every resident/owner with visible wires must make arrangements to have the wires redirected through the utility chase (or chute) that runs up the middle of each unit, behind the upstairs phone stand. Please turn the page for a descriptive diagram.

For color renderings of the diagram and example photos of out-of-compliance installations, please visit www.mybordeauxvillage.com.

How To Re-Install Your Cables

Please arrange to have your satellite wiring installed through the utility chase (chute), which will bring the installation into compliance. Please turn the page for a diagram.

Options:

- Call White Gloves (CCMC's for-a-fee provider service), for a cost of \$350 for 2 men for 2 hours to re-install. White Glove Services can be reached at 469-246-3505
- Call the phone or satellite company for a return visit
- Arrange with a handy-person to undertake this project

In the past, the Bordeaux Village HOA may not have fully enforced the community standards regarding wiring, and sometimes allowed exterior wiring. With all the exterior work being undertaken, many of these wiring issues are now being fully exposed due to tree removal and anticipated painting. Community standards will be a new focus for the Bordeaux Village HOA. Thank you very much for your interest in the beauty and resale value of the property.

Deadlines

Please have your exterior wires moved to accommodate community standards by June 15th, the anticipated completion date of the maintenance and rehabilitation project.

Not Using Your Satellite Dish or Cable Wires?

If you would like your satellite dish and wires permanently removed, please contact BV's Property Manager Michele Drain at mdrain@ccmcnet.com for professional removal at *no cost to you*.

Construction Questions:

Chet Farnsworth 817-825-5612

General -- CCMC:

Michele Drain 469-246-3507

Bordeaux Village Satellite/Cable Routing

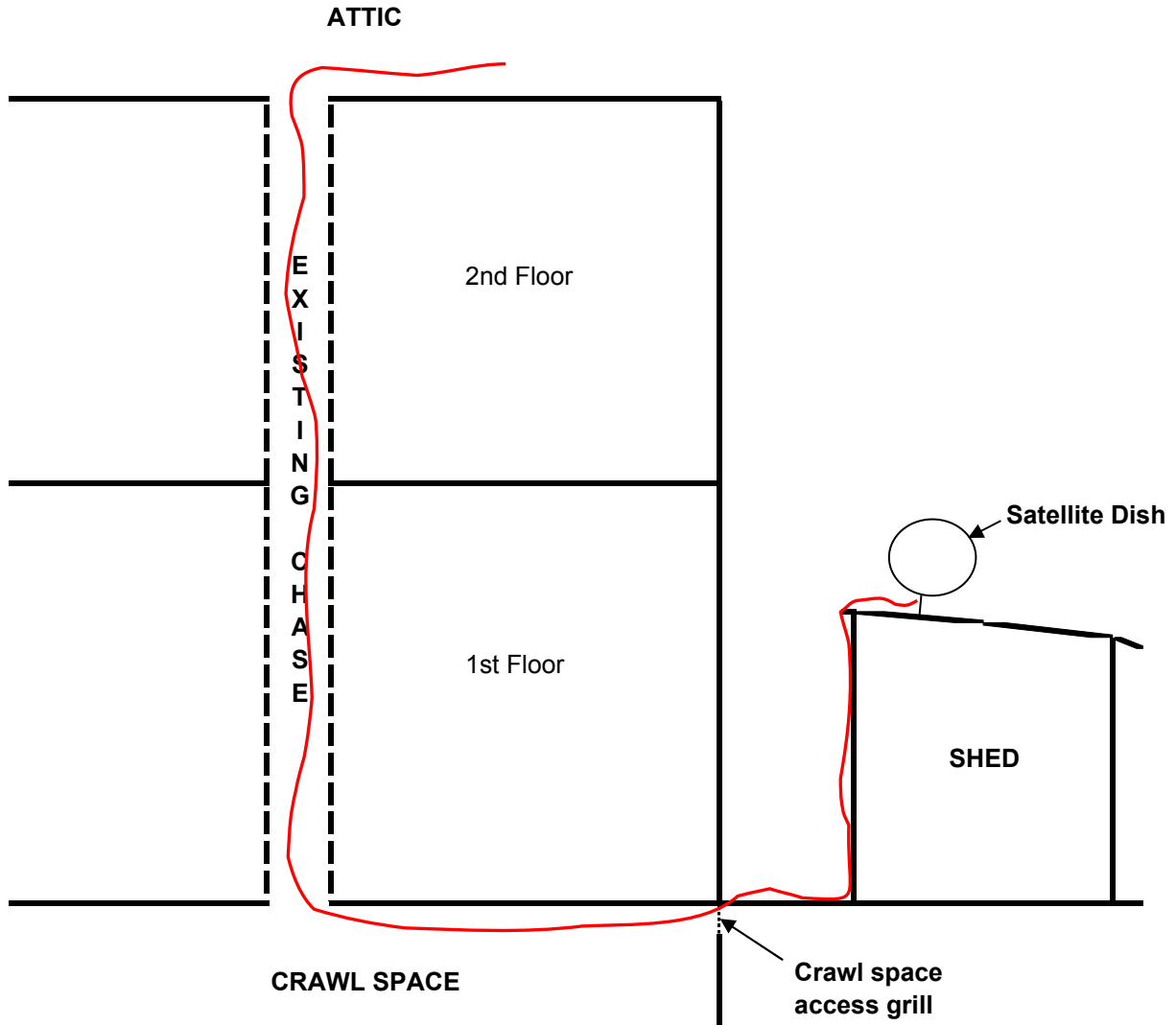

NOTES:

1) The Existing Chase shown is a utility chase or chute that is an approximate 2'x 2' cavity that runs from the attic to the crawl space. It is located behind the phone stand in the upstairs landing and the back of the right hand side of the second bedroom closet.

Improper Installation
Not Permitted



Bordeaux Village HOA
Examples of Improper Cable/Wiring Installation

Improper Installation
Not Permitted



Bordeaux Village HOA
Examples of Improper Cable/Wiring Installation

Improper Installation
Not Permitted



Bordeaux Village HOA
Examples of Improper Cable/Wiring Installation

Improper Installation
Not Permitted

Bordeaux Village HOA
Examples of Improper Cable/Wiring Installation

